

**N NARGESA®**

POWER HAMMER

**MP60**



**years**

**manufacturing industrial machinery**



|                     |
|---------------------|
| <b>AENOR</b>        |
| R&D&I<br>MANAGEMENT |
| UNE 166002          |

# TECHNICAL FEATURES

The Drop Hammer MP60 with compressor incorporated, to make all kind of pieces for the ornamental forging. It's got 60 kg stroke.

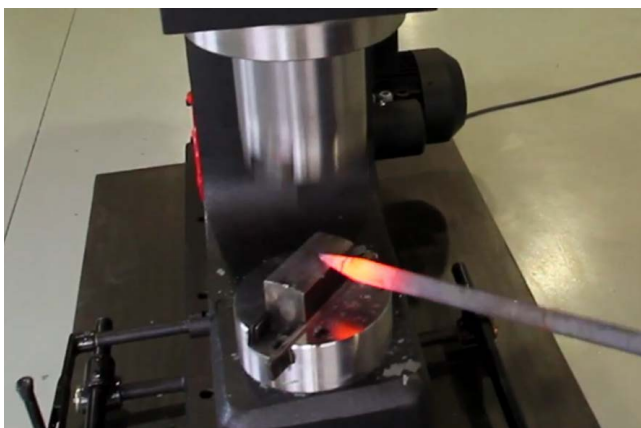

- > Compressor incorporated: No need for any external compressor.
- > Frame made of welded and mechanized steel, it isn't made of casting.
- > Automatic greasing system.
- > Cylinders made of GG21 to ensure a good performance.
- > Orientable cylinder to ease up the operative work.
- > Front protection against any projections.
- > Protection for the driving pedal.
- > Electric protection of the engine.
- > Emergency stop.
- > Moulds made of a special steel to stand big impacts at quite high temperatures.
- > Great variety of tooling and exchangeable moulds.
- > Manufacturing of tooling as requested.

## > Nominal dropping weight

60 Kg.

## > Strokes per minute

220.

## > Strokes maximum displacement

230 mm.

## > Maximum round working capacity

70 mm.

## > Maximum square working capacity

60x60 mm.

## > Engine power

5,5 Kw.

## > Weight

1190 Kg.

*\* All our products are manufactured in our facilities in Spain. The hydraulic and electrical components are all standard from the best leading European trademarks, with technical assistance all over the world: Rexroth, Bosch, Roquet, Schneider Electric, LG, Telemecanique, Pizzato etc...*

## OUTSIDE DIMENSIONS

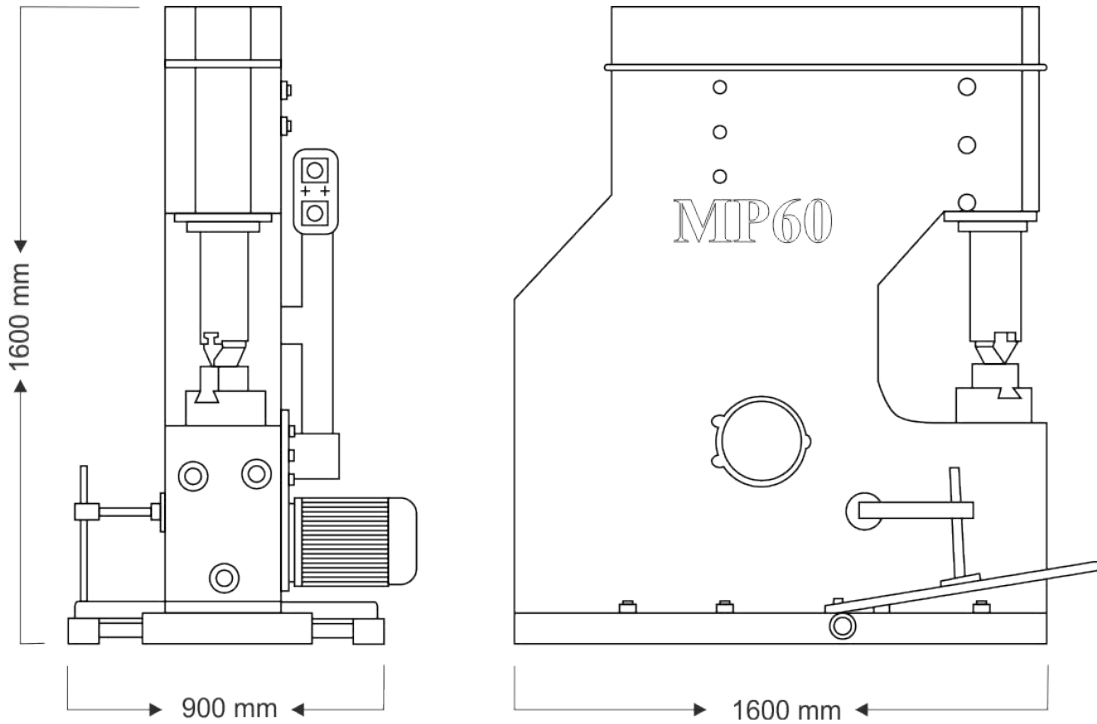

## PACKAGING CHARACTERISTICS

- Tariff Item Code: 84621990
- Lower bench palletized to easily transport the machine to the workplace or store it in case of lacking space.
- The machine is shipped fully assembled.
- Pallet made of steel and 3 layer cardboard box suitable for seafreight.
- Optional: Fumigated wooden box NIMF15.

### MP60

|              |                     |
|--------------|---------------------|
| Width        | 1000 mm             |
| Depth        | 2200 mm             |
| Height       | 1820 mm             |
| Volume       | 4,01 m <sup>3</sup> |
| Net Weight   | 1190 Kg             |
| Gross Weight | 1248 Kg             |

# STANDARD ACCESSORIES DELIVERED WITH THE MACHINE

## Standard flat mould

---

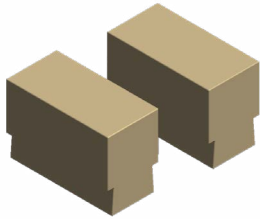

**REF:** 140-14-01-00001

- > All our Power-hammers or Martinetes MP Nargesa are equipped with an upper standard flat tooling and lower one.
- > This tooling is the most versatile one and it's bond to the operatives skilfulness.
- > It's made of a special treated steel to stand hard strokes at very high temperatures.

**N° of pieces:** 2

**Dimensions:** 60x120x85



## OPTIONAL ACCESSORIES

### Optional tooling MP60

---



- > All models of power-hammers MP have a wide catalogue of moulds to make all kind of pieces. We also manufacture tooling as requested to make parts according to the customer's design.
- > In the PDF file you will be able to download the list of standard moulds we can offer.

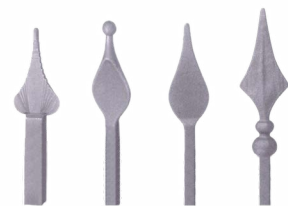

Standard moulds